

PRODUCT USE GUIDE

QUICK
INSTALLATION
GUIDE

SG-286

2.0 MULTIMEDIA SOUNDBAR

TECH SPECS

Wireless version: BT5.3
Speaker size: 2.5 inches*2
Speaker power: 5W*2
Impedance: 4Ω*2
Sensitivity: 500mv±50mv
Frequency response: 60 Hz - 20 KHz
Power supply: DC-5V  1A
Mode: BT & AUX
SNR: >50dB
Backlight: RGB
Connectors: USB
Size: 422 x 95 x 67 mm
Cable length: 1.5 m

www.marvo-tech.com

QUICK
INSTALLATION
GUIDE

PRODUCT PRESENTATION

1. FEATURES

- Excellent and nice visual lighting effect, a variety of RGB lighting effects
- Excellent audio quality with powerful bass sounds and clear treble
- BT & AUX connection, adapt to the needs of all kinds of devices.

2. SYSTEM REQUIREMENTS

PC system or compatible with the installed sound card, one USB port available;
Wireless compatible device.

Cellphone, iPad, and Mobile Devices (Bluetooth Mode)

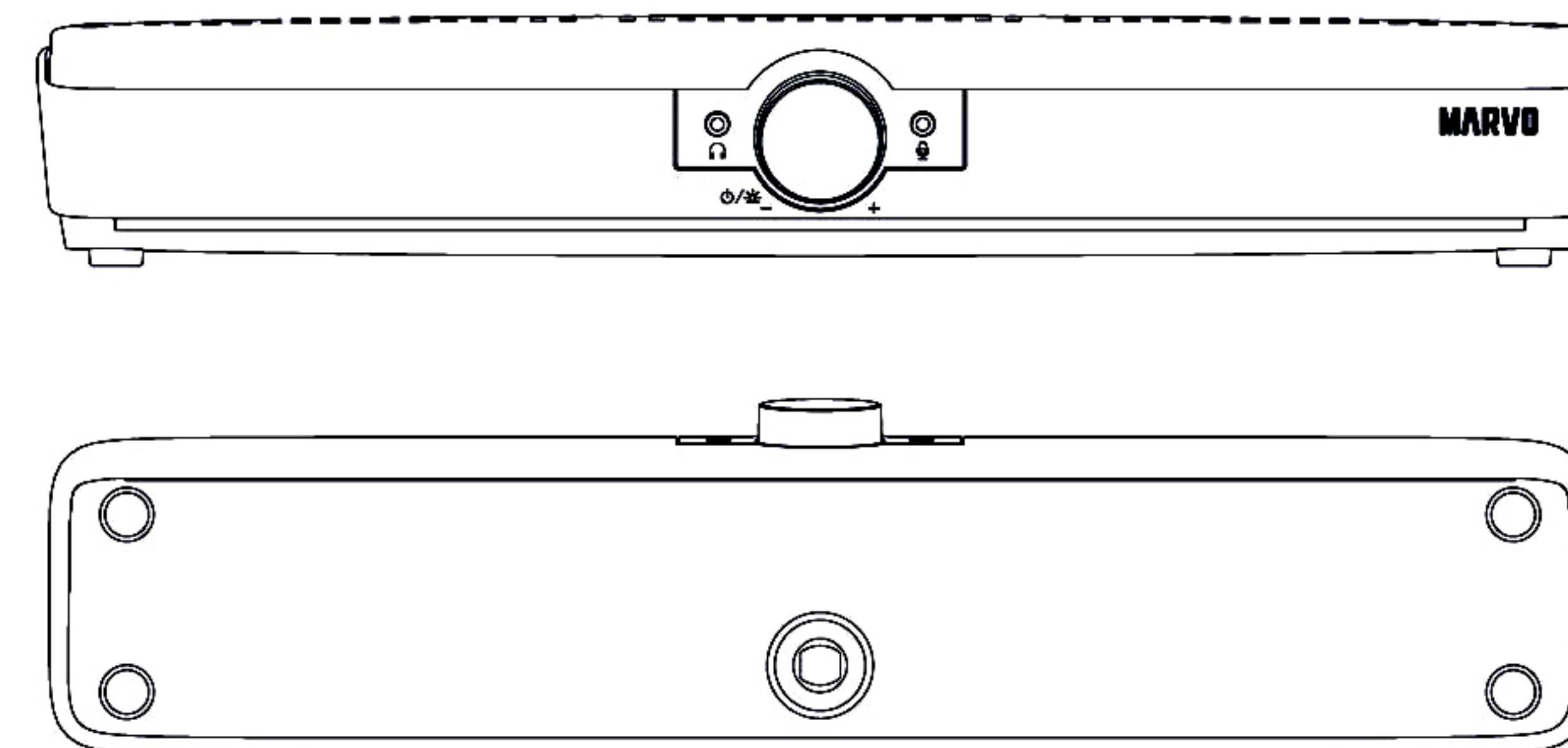

QUICK
INSTALLATION
GUIDE

SAFETY NOTES

- Keep the equipment dry. Keep away from precipitation, humidity, all types of liquids and condensation.
- Do not use the product with wet hands.
- Do not use or store the equipment in dusty or dirty areas.
- Do not store the equipment under high-temperature or low-temperature conditions (this may damage it).
- Do not drop, knock or shake the equipment (use may result in breakage).

INSTALLATION

Connect the audio jack to the line-out connector on the sound card. Insert the USB connector into a USB port on your computer.

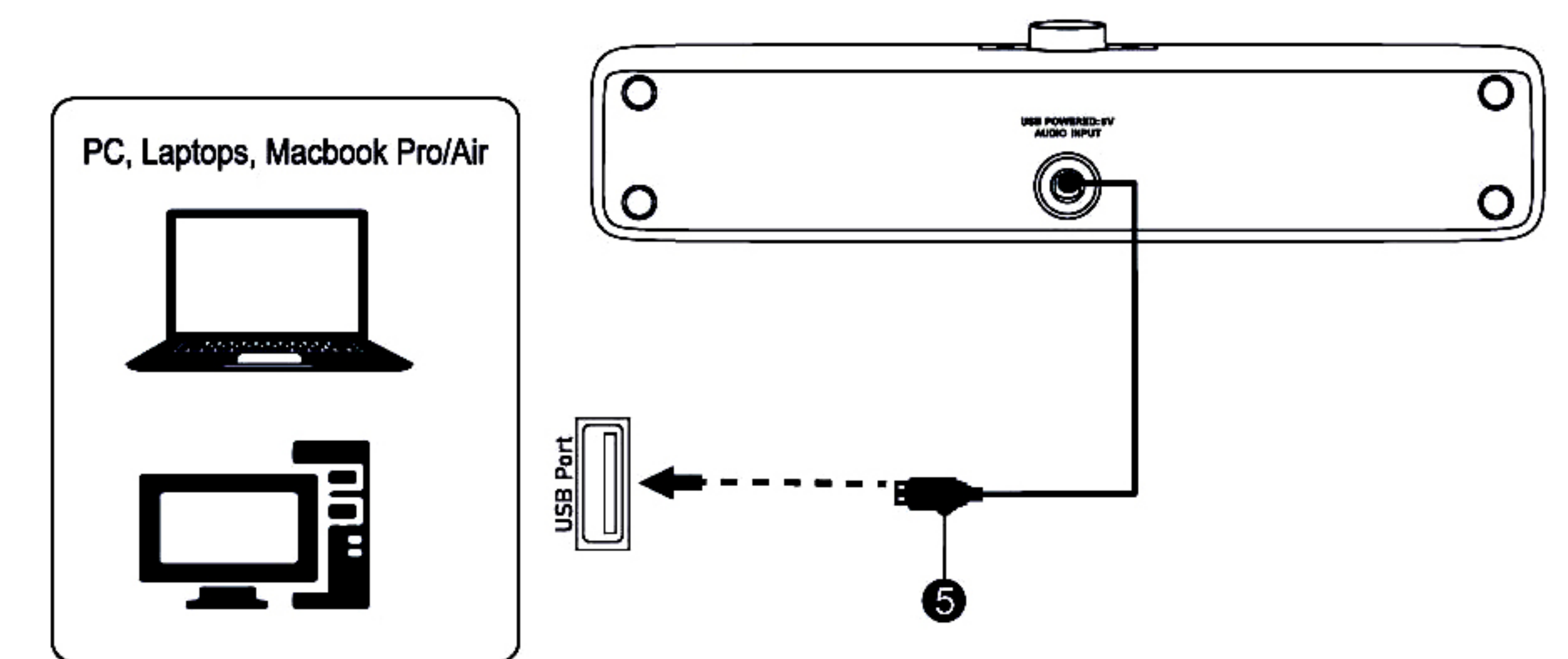

www.marvo-tech.com

QUICK
INSTALLATION
GUIDE

USE

AUX-IN mode

Press and hold the knob for power on, the default is AUX mode. Plug the Soundbar USB into the available USB port of the device to connect successfully.

BT connection method

Double-click the knob switch to the BT mode. Open the BT device to search for the BT name "SG-286", click connect to use the BT mode.

Power on/off

Press and hold the knob to turn the power on/off.

Adjust the volume

Rotate the knob left and right to adjust the volume level.

Switching the light mode

Short press the knob to switch the light mode.

Switching BT & AUX

Double-click the knob to switch BT & AUX modes.

External interface

External 3.5mm audio jack; external 3.5mm MIC jack.

Bluetooth status, call status need to connect external MIC;
In the call state, short press the knob to answer the call or hang up the phone.

QUICK
INSTALLATION
GUIDE

TROUBLESHOOTING

In case of incorrect operation follow the steps below:

- Check the integrity of the connectors;
 - Check the connection to the computer correctly;
 - Check the correctness of your computer settings;
 - Disconnect and reconnect the equipment; restart the computer.
- If the problem persists, please contact your local seller.

GENERAL INFORMATION

- Unauthorized repairs or disassembly of the product will void the warranty and may cause its damage.
- This product is safe and complies to EU requirements.
- This product is manufactured conforming with the European RoHS standard. This standard was introduced to reduce the amount of electrical and electronic waste emitted into the atmosphere.
- Using the WEEE symbol (the crossed-out bin) indicates that this product is not household waste. When recycling waste properly, you protect the environment and people health. Segregated household waste collection, aids recycle materials and components used for the production of this device. For detailed information about recycling, please contact your retailer or a local authority.

QUICK
INSTALLATION
GUIDE

Warranty Card

Product Model: _____

Product Serial No: _____

Date of Purchase: _____

Customer Name: _____

TEL: _____

Address: _____

Distributor Name: _____

TEL: _____

Warranty Card is the important certificate for
after-sale service of Marvo products, please keep it safe.

NOTE:
Specifications and design are subject to change without notice due to
product improvements.

www.marvo-tech.com

MARVO[®]
TOUGH WISDOM



FACEBOOK
Scan Me



Want to Know More ?
Scan Me